

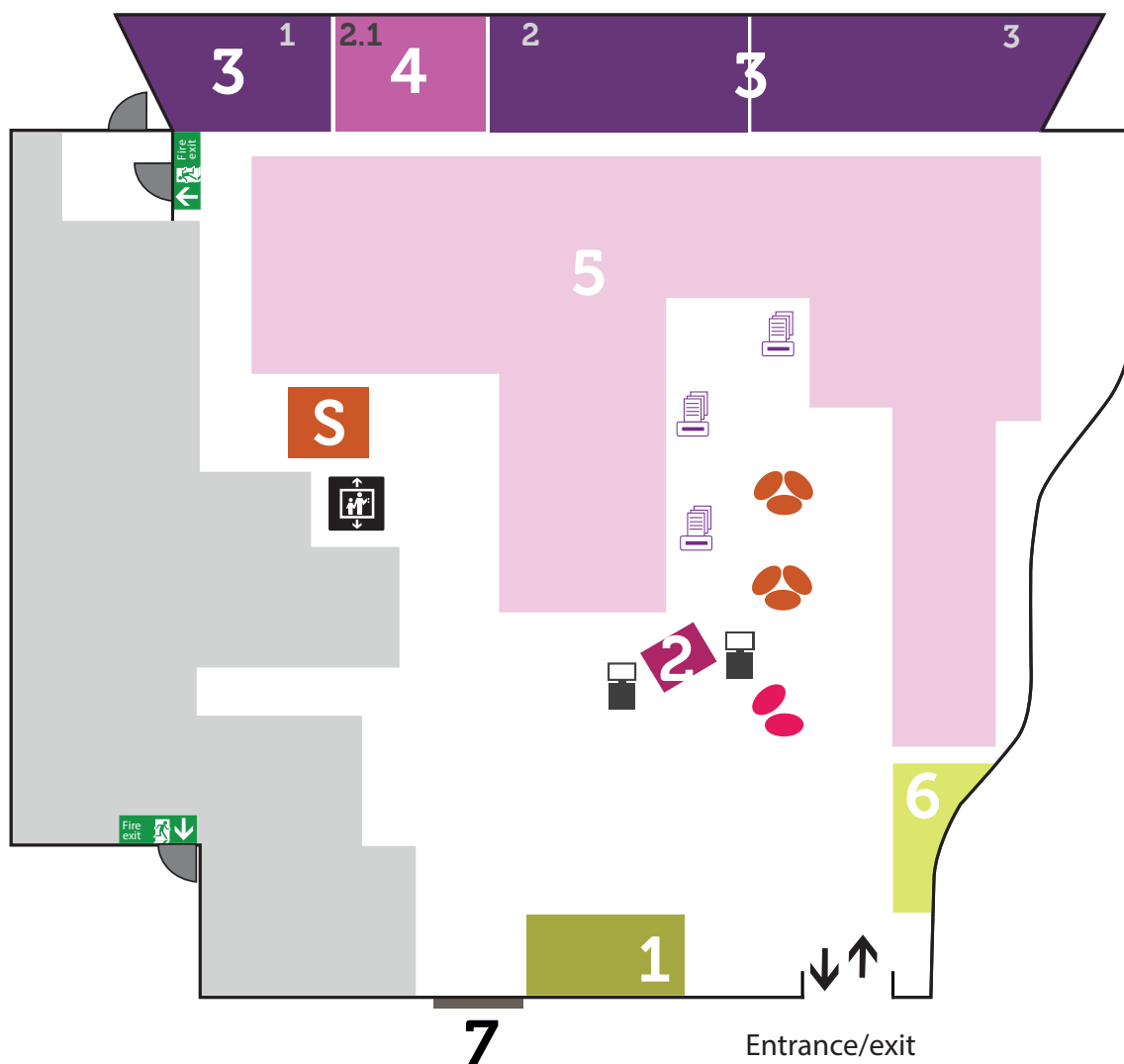













# Welcome to Bundoora Library

Building 210 Level 2



- |   |                            |   |                           |
|---|----------------------------|---|---------------------------|
|  1 | Study Support Hub          |  | Ask the Library Terminals |
|  2 | Holds pick-up              |  | Express PCs               |
|  3 | Seminar rooms              |  | Printer/scanner/copier    |
|  4 | Group Study/Assistive Tech |  | Emergency exit            |
|  5 | Group study/computers      |  | Stationery machine        |
|  6 | New books                  |  | Self-service borrowing    |
|  7 | Library returns            |  | Lift                      |

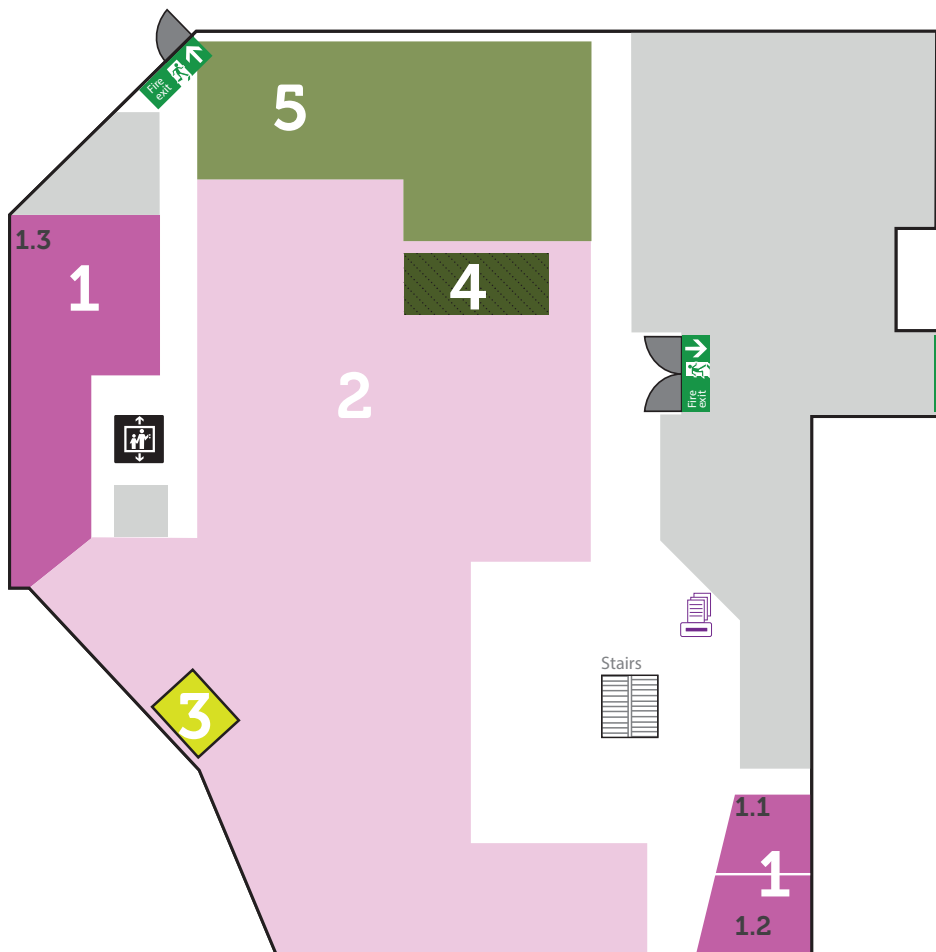

### Level 1

- 1 Group study room
- 2 Group study area
- 3 Microfiche/microfilm printer
- 4 Periodicals
- 5 Compactus
- Printer/scanner/copier
- Emergency exit
- Lift

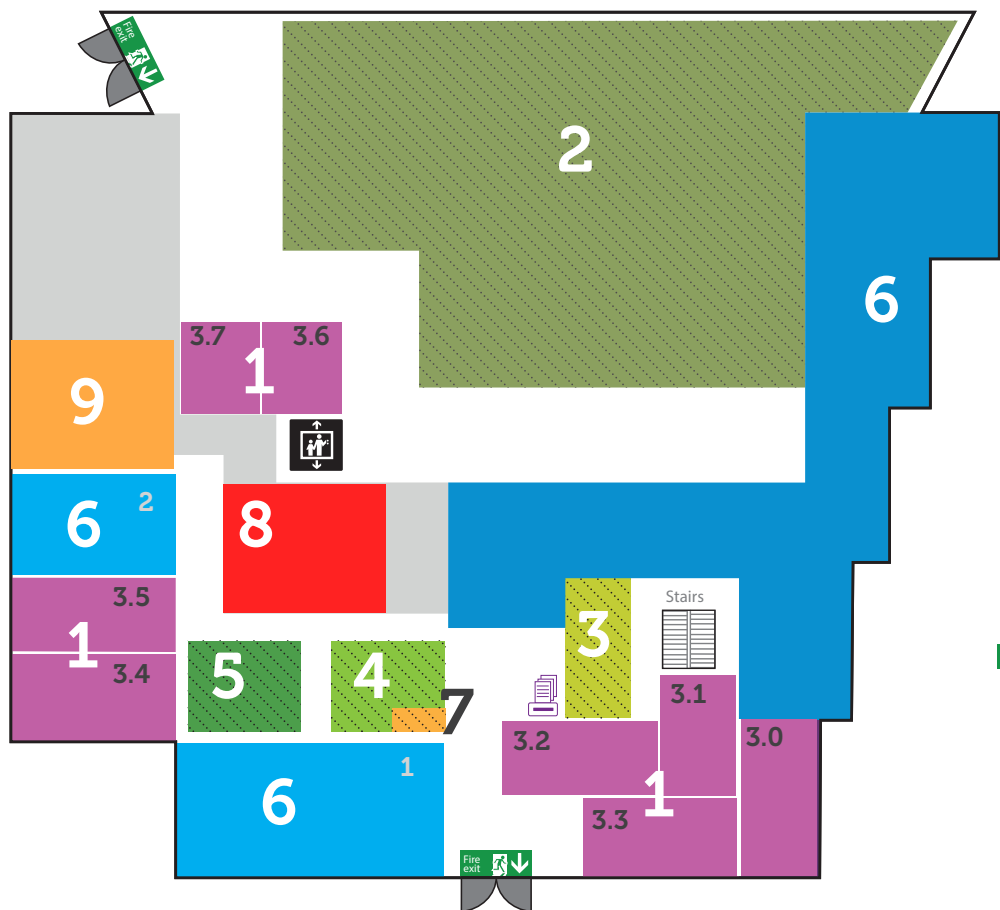

### Level 3

- 1 Group study room
- 2 Books
- 3 Audiovisual large collection
- 4 Childrens collection
- 5 Audiovisual
- 6 Quiet study area
- 7 Posters
- 8 Microscopy Reading Room
- 9 Online Study Zone
- Printer/scanner/copier
- Emergency exit
- Lift